

说明:

1. 胶芯: LCP 黑色; UL94V-0.
2. 端子: C2680 T=0.15mm, 半金镍1u" (功能)
3. 外壳: SUS304 T=0.25mm, 镀镍
4. 额定电流: 1 A 最大.
5. 耐电压: 100V(AC) /1分钟 至少.
6. 接触阻抗: 50m Ω 最大.
7. 绝缘阻抗: 100M Ω 最小.
8. 插入力: 3.57 Kgf 最大.
9. 拔出力: 1.0 Kgf 初始 最小; 测试后 0.81 Kgf 最小
10. 温度范围: -30°C~+80°C

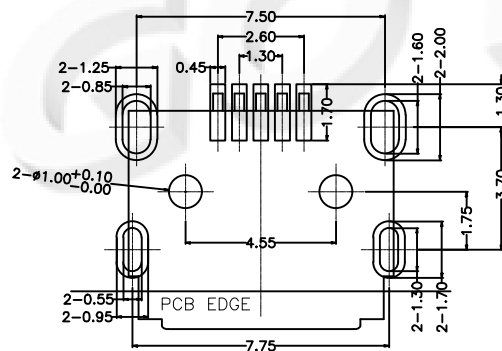
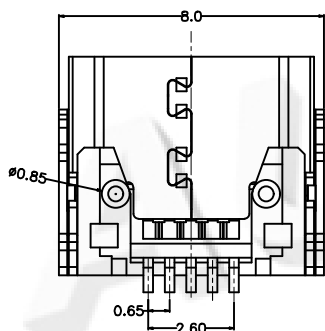
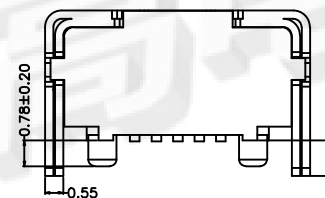
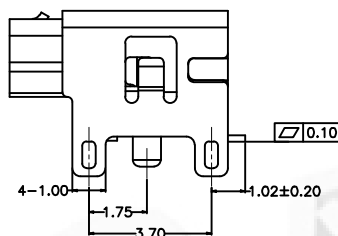
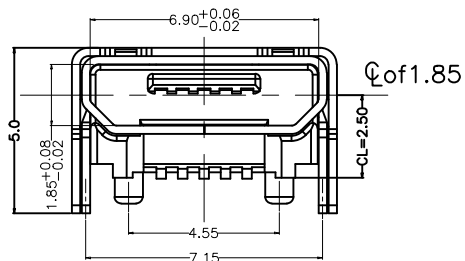
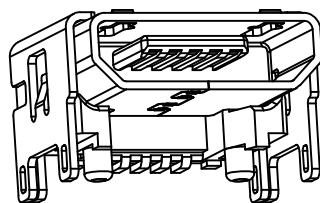
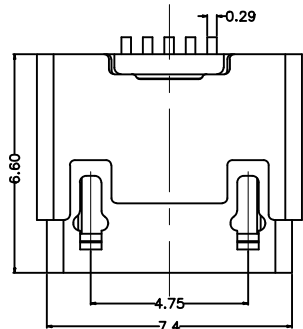

RECOMMENDED PCB LAYOUT

TOL:±0.10(TOP VIEW)

| | | | | | |
|----|---------|------|-----|---------------------------|-------------------------------|
| ④ | CONTACT | ---- | 5 | Copper Alloy T=0.20 | Au/Sn Plated, Ni Under plated |
| ③ | SHELL | ---- | 1 | Stainless Steel T=0.25 | Ni/Cu PLATED |
| ② | COVER | ---- | 1 | Stainless Steel T=0.25 | Ni/Cu PLATED |
| ① | HOUSING | ---- | 1 | LCP | Black, UL94V-0 |
| NO | PART | P/N | NUM | MATERIAL | MARK |

DONGGUAN AUGO ELECTRONICS CO.,LTD.

COPYRIGHT RESERVED, PLEASE DO NOT COPY.

| | | | | | | | |
|--------------|-----------|--------------------------|------|---------|-----------|---------|----|
| PART NAME | | CONNECTOR | | DRAWING | Y,C,ZHANG | DWG.No. | |
| PART NO. | | MICRO 5P BH2.5 WSL1.0 NC | | CHECK | G.C.Chen | REV. | A1 |
| UNIT : mm | TOLERANCE | UP TO 5 | ±0.2 | ANGLE | APPROVAL | DATE | |
| | OTHERWISE | ABOVE 5~30 | ±0.3 | | | | |