

RoHS
Compliant

SYMBOL	REVISION	APPROVAL	DATE

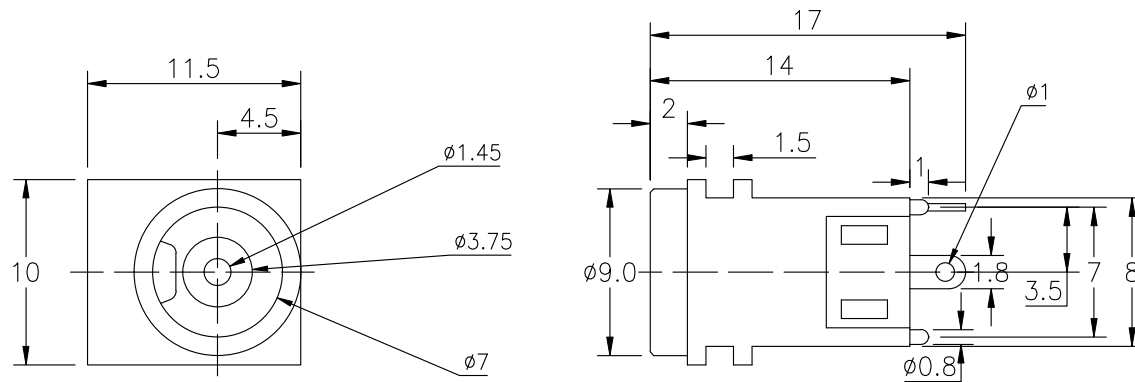

NOTES:

- 1.ELECTRIC CHARACTERISTICS:
 - 1-1.CONTACT CURRENT RATING: 4A.
 - 1-2.CONTACT VOLTAGE RATING: 20V DC.
 - 1-3.CONTACT RESISTANCE: 30mΩ MAX.;
 - 1-4.DIELECTRIC WITHSTANDING VOLTAGE: 500V AC;
 - 1-5.INSULATION RESISTANCE: 100MΩ MIN.AT DC 500V.
- 2.MECHANICAL CHARACTERISTICS:
 - 2-1.DURABILITY:3000 CYCLES.
 - 2-2.INSERTION AND EXTRACTION FORCE:
 - 2-2.1.INSERTION FORCE: 30N MAX.
 - 2-2.2.EXTRACTION FORCE: 3N MIN.
- 3.ENVIRONMENT CHARACTERISTICS:
 - 3-1.OPERATING TEMPERATURE:-25℃~+85℃.
 - 3-2.HUMIDITY:45~85% RH.

ELECTRICAL SCHEMATIC

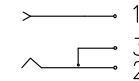

5	底座	1	LCP	BLACK
4	盖脚	1	磷铜 T=0.2mm	Ag PLATED
3	开关静片	1	黄铜 T=0.25mm	Ag PLATED
2	开关弹片	1	磷铜 T=0.3mm	Ag PLATED
1	电极中心柱	1	黄铜	CuSn PLATED
NO.	PART NAME	Q'TY	MATERIAL	PLATING & COLOR

DONGGUAN AUGO ELECTRONICS CO.,LTD.

COPYRIGHT RESERVED,PLEASE DO NOT COPY.

PART NAME		DC POWER JACK			DRAWING		G.C.Chen		DWG.No.	
PART NO.		DC-037			CHECK		G.C.Chen		REV. A	
UNIT :	mm	TOLERANCE OTHERWISE	UP TO 10	±0.1	ANGLE	APPROVAL		DATE		
			ABOVE 10~20	±0.15		SCALE		PAGE		
		OTHERWISE		ABOVE 20~50	±0.2	2:1		1 OF 1		